

## 60x60x10 mm

- \* Frame: Plastic (Black) 94V-0
- \* Impeller: Plastic (Black) 94V-0
- \* Lead Wires: UL type or Equivalent,AWG#28,Red +,Black -
- \* Operating Temperature: -25°C~+70°C, 5%~90%RH
- \* Storage Temperature: -40°C~+80°C, 5%~90%RH
- \* Weight: 24.0g

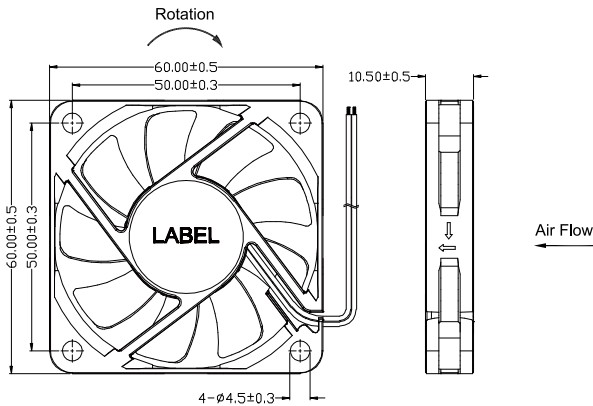

### ■ Dimensions(Unit:mm)



### ■ Mounting panel cutout(Unit:mm)

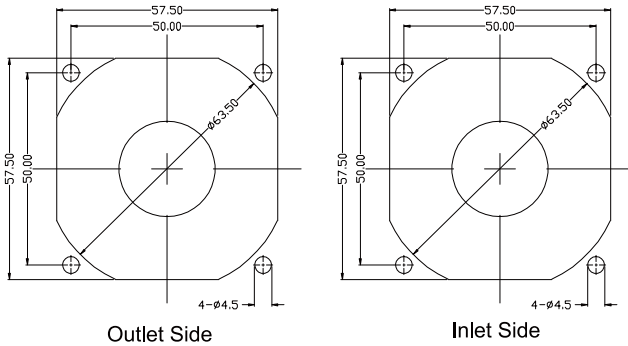

### ■ P&Q Curve

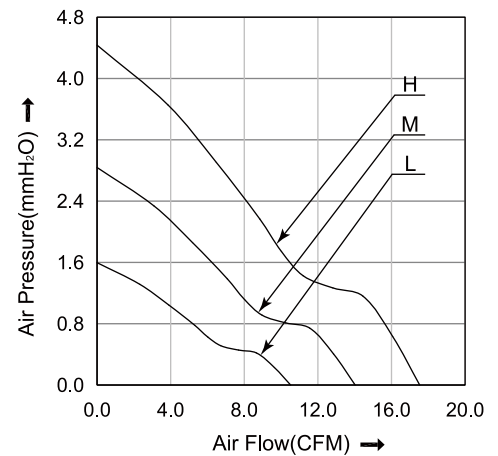

### ■ Specifications

Model No.	Rated Voltage	Operating Voltage	Rated Current	Speed	Max. Air Flow		Max. Static Pressure		Noise
	VDC	VDC	A	RPM	m <sup>3</sup> /min	CFM	mmH <sub>2</sub> O	inH <sub>2</sub> O	dB
HD6010L05	5	4.0~5.75	0.21	3000	0.30	10.50	1.60	0.06	22.5
HD6010M05	5	4.0~5.75	0.35	4000	0.40	14.00	2.80	0.11	29.0
HD6010L12	12	7.0~13.8	0.13	3000	0.30	10.50	1.60	0.06	22.5
HD6010M12	12	7.0~13.8	0.18	4000	0.40	14.00	2.80	0.11	29.0
HD6010H12	12	7.0~13.8	0.23	5000	0.50	17.50	4.40	0.17	34.0
HD6010L24	24	14.0~27.6	0.06	3000	0.30	10.50	1.60	0.06	22.5
HD6010M24	24	14.0~27.6	0.09	4000	0.40	14.00	2.80	0.11	29.0
HD6010H24	24	14.0~27.6	0.13	5000	0.50	17.50	4.40	0.17	34.0

**Note:**

Bearing Type: Ball Bearing-----B, Sleeve Bearing-----S, Hydraulic Bearing-----R

Function description:

A:3rd Pulse Wire      F:Techometer / Speed Sensor      R:Alarm/high  
 Q:Alarm/low    S:Alarm/high-low      W:PWM Control input