

# HD5020 SERIES

## 50x50x20 mm

- \* Frame: Plastic (Black) 94V-0
- \* Impeller: Plastic (Black) 94V-0
- \* Lead Wires: UL type or Equivalent,AWG#28,Red +,Black -
- \* Operating Temperature: -25°C~+70°C, 5%~90%RH
- \* Storage Temperature: -40°C~+80°C, 5%~90%RH
- \* Weight: 32.0g

### ■ Dimensions(Unit:mm)

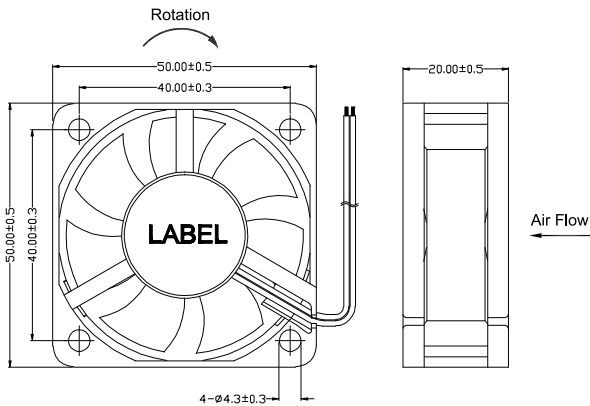

### ■ P&Q Curve

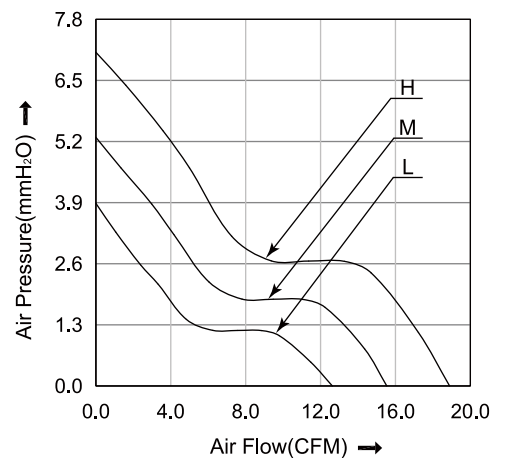

### ■ Mounting panel cutout(Unit:mm)

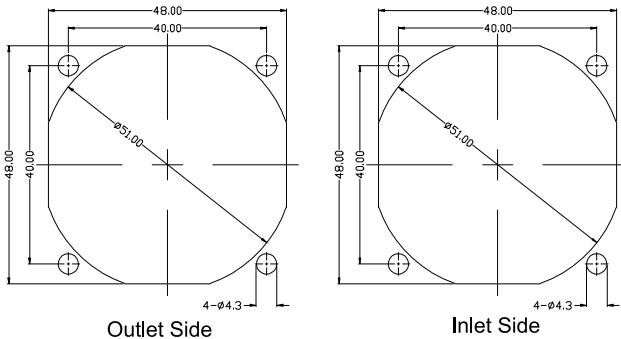

### ■ Specifications

Model No.	Rated Voltage	Operating Voltage	Rated Current	Speed	Max. Air Flow		Max. Static Pressure		Noise
	VDC	VDC	A	RPM	m <sup>3</sup> /min	CFM	mmH <sub>2</sub> O	inH <sub>2</sub> O	dB
HD5020L05	5	4.0~5.75	0.23	4000	0.36	12.60	3.90	0.15	26.0
HD5020M05	5	4.0~5.75	0.27	5000	0.44	15.50	5.30	0.21	31.5
HD5020H05	5	4.0~5.75	0.35	6000	0.54	18.90	7.10	0.28	37.5
HD5020L12	12	7.0~13.8	0.13	4000	0.36	12.60	3.90	0.15	26.0
HD5020M12	12	7.0~13.8	0.18	5000	0.44	15.50	5.30	0.21	31.5
HD5020H12	12	7.0~13.8	0.23	6000	0.54	18.90	7.10	0.28	37.5
HD5020L24	24	14.0~27.6	0.06	4000	0.36	12.60	3.90	0.15	26.0
HD5020M24	24	14.0~27.6	0.09	5000	0.44	15.50	5.30	0.21	31.5
HD5020H24	24	14.0~27.6	0.13	6000	0.54	18.90	7.10	0.28	37.5

Note:

Bearing Type: Ball Bearing-----B, Sleeve Bearing-----S, Hydraulic Bearing-----R

Function description:

A:3rd Pulse Wire                      F:Tachometer / Speed Sensor                      R:Alarm/high

Q:Alarm/low    S:Alarm/high-low                      W:PWM Control input