

# HD3510 SERIES

## 35x35x10 mm

- \* Frame: Plastic (Black) 94V-0
- \* Impeller: Plastic (Black) 94V-0
- \* Lead Wires: UL type or Equivalent, AWG#28, Red +, Black -
- \* Operating Temperature: -25°C~+70°C, 5%~90%RH
- \* Storage Temperature: -40°C~+80°C, 5%~90%RH
- \* Weight: 10.0g

### ■ Dimensions(Unit:mm)

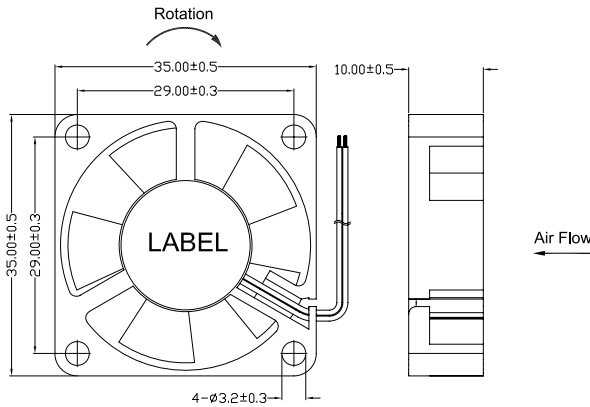

### ■ P&Q Curve

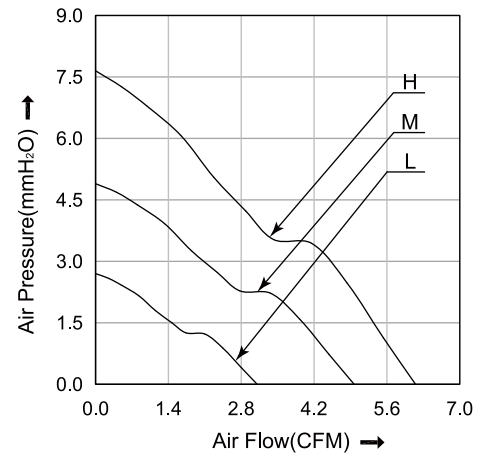

### ■ Mounting panel cutout(Unit:mm)

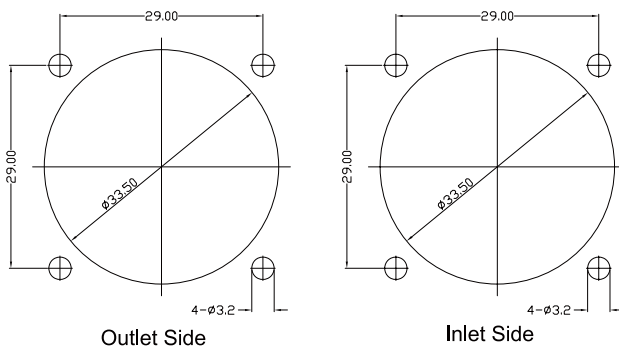

### ■ Specifications

Model No.	Rated Voltage	Operating Voltage	Rated Current	Speed	Max. Air Flow		Max. Static Pressure		Noise
	VDC	VDC	A	RPM	m <sup>3</sup> /min	CFM	mmH <sub>2</sub> O	inH <sub>2</sub> O	dB
HD3510L05	5	4.0~5.75	0.18	5000	0.09	3.10	2.70	0.11	20.5
HD3510M05	5	4.0~5.75	0.25	8000	0.14	4.90	4.90	0.19	28.4
HD3510H05	5	4.0~5.75	0.35	11000	0.17	6.10	7.60	0.30	35.8
HD3510L12	12	7.0~13.8	0.09	5000	0.09	3.10	2.70	0.11	20.5
HD3510M12	12	7.0~13.8	0.13	8000	0.14	4.90	4.90	0.19	28.4
HD3510H12	12	7.0~13.8	0.18	11000	0.17	6.10	7.60	0.30	35.8
HD3510L24	24	14.0~27.6	0.06	5000	0.09	3.10	2.70	0.11	20.5
HD3510M24	24	14.0~27.6	0.09	8000	0.14	4.90	4.90	0.19	28.4
HD3510H24	24	14.0~27.6	0.13	11000	0.17	6.10	7.60	0.30	35.8

Note:

Bearing Type: Ball Bearing-----B, Sleeve Bearing-----S, Hydraulic Bearing-----R

Function description:

A:3rd Pulse Wire

F:Techometer / Speed Sensor

R:Alarm/high

Q:Alarm/low S:Alarm/high-low

W:PWM Control input