

HD2010 SERIES

20x20x10 mm

- * Frame: Plastic (Black) 94V-0
- * Impeller: Plastic (Black) 94V-0
- * Lead Wires: UL type or Equivalent, AWG#28, Red +, Black -
- * Operating Temperature: -25°C~+70°C, 5%~90%RH
- * Storage Temperature: -40°C~+80°C, 5%~90%RH
- * Weight: 6.0g



■ Dimensions(Unit:mm)

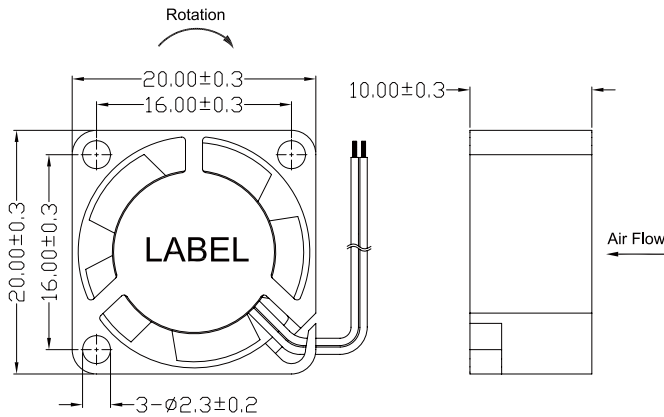

■ Mounting panel cutout(Unit:mm)

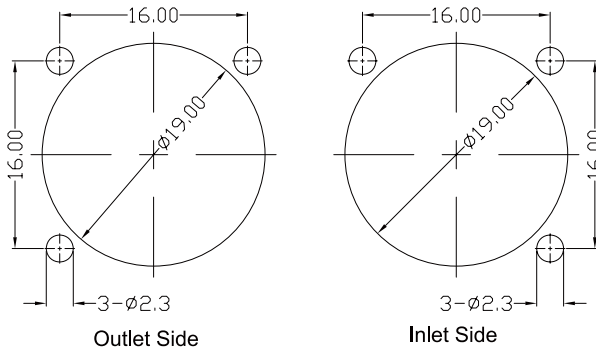

■ P&Q Curve

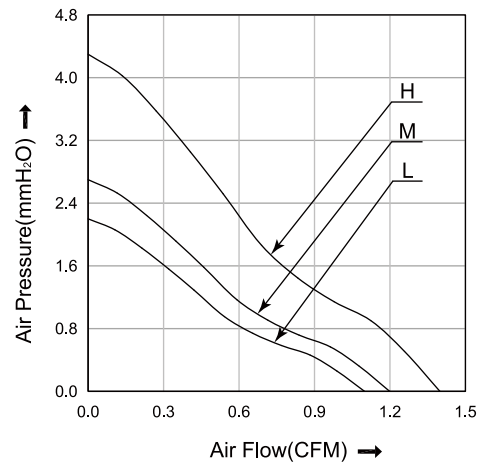

■ Specifications

Model No.	Rated Voltage	Operating Voltage	Rated Current	Speed	Max. Air Flow		Max. Static Pressure		Noise
	VDC	VDC	A	RPM	m ³ /min	CFM	mmH ₂ O	inH ₂ O	dB
HD2010L05	5	4.0~5.75	0.06	10000	0.03	1.10	2.20	0.09	18.8
HD2010M05	5	4.0~5.75	0.08	12000	0.03	1.20	2.70	0.11	21.3
HD2010H05	5	4.0~5.75	0.13	14000	0.04	1.40	4.30	0.17	24.2
HD2010L12	12	7.0~13.8	0.03	10000	0.03	1.10	2.20	0.09	18.8
HD2010M12	12	7.0~13.8	0.05	12000	0.03	1.20	2.70	0.11	21.3
HD2010H12	12	7.0~13.8	0.08	14000	0.04	1.40	4.30	0.17	24.2

Note:

Bearing Type: Ball Bearing-----B, Sleeve Bearing-----S, Hydraulic Bearing-----R

Function description:

A:3rd Pulse Wire

F:Techometer / Speed Sensor

R:Alarm/high

Q:Alarm/low S:Alarm/high-low

W:PWM Control input