

HB1340 SERIES

135x144x40 mm

- * Frame: Plastic (Black) 94V-0
- * Impeller: Plastic (Black) 94V-0
- * Lead Wires: UL type or Equivalent, AWG#28, Red +, Black -
- * Operating Temperature: -25°C~+70°C, 5%~90%RH
- * Storage Temperature: -40°C~+80°C, 5%~90%RH
- * Weight: 352.0g



■ P&Q Curve

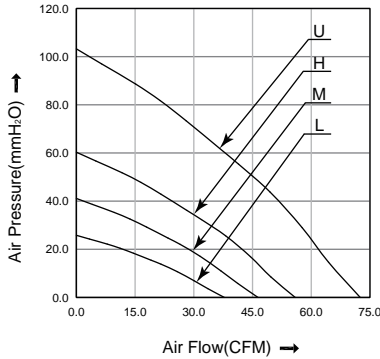

■ Dimensions(Unit:mm)

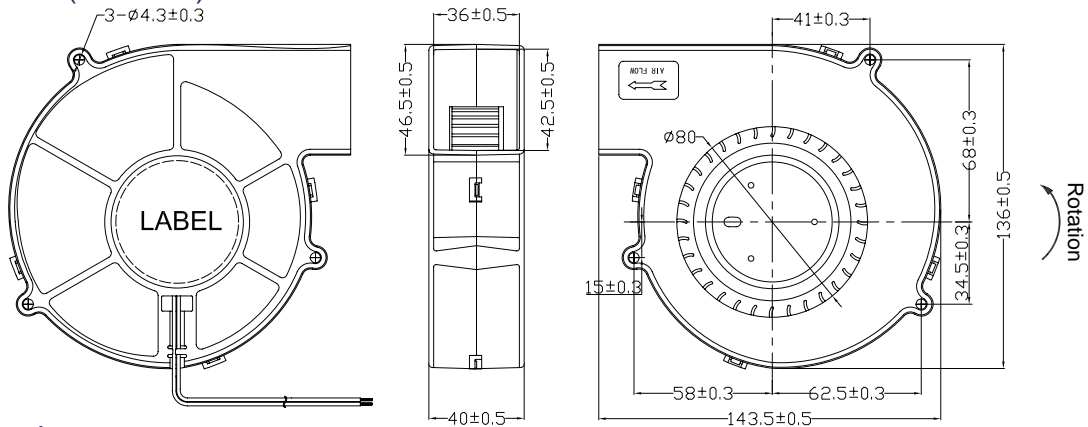

■ Specifications

Model No.	Rated Voltage	Operating Voltage	Rated Current	Speed	Max. Air Flow		Max. Static Pressure		Noise
	VDC	VDC	A	RPM	m ³ /min	CFM	mmH ₂ O	inH ₂ O	
HB1340L12	12	7.0~13.8	1.00	2000	1.07	37.80	25.80	1.02	53.2
HB1340M12	12	7.0~13.8	1.40	2500	1.31	46.40	41.10	1.62	55.7
HB1340H12	12	7.0~13.8	2.00	2800	1.58	55.90	60.30	2.38	58.2
HB1340U12	12	7.0~13.8	4.00	3800	2.05	72.50	103.20	4.07	65.4
HB1340L24	24	14.0~27.6	0.50	2000	1.07	37.80	25.80	1.02	53.2
HB1340M24	24	14.0~27.6	0.70	2500	1.31	46.40	41.10	1.62	55.7
HB1340H24	24	14.0~27.6	1.00	2800	1.58	55.90	60.30	2.38	58.2
HB1340U24	24	14.0~27.6	2.00	3800	2.05	72.50	103.20	4.07	65.4
HB1340L48	48	28.0~56.0	0.30	2000	1.07	37.80	25.80	1.02	53.2
HB1340M48	48	28.0~56.0	0.40	2500	1.31	46.40	41.10	1.62	55.7
HB1340H48	48	28.0~56.0	0.50	2800	1.58	55.90	60.30	2.38	58.2
HB1340U48	48	28.0~56.0	1.00	3800	2.05	72.50	103.20	4.07	65.4

Note:

Bearing Type: Ball Bearing-----B, Sleeve Bearing-----S, Hydraulic Bearing-----R

Function description:

A:3rd Pulse Wire

F:Techometer / Speed Sensor

R:Alarm/high

Q:Alarm/low S:Alarm/high-low

W:PWM Control input